

INDUSTRIAL MAGZA
DIST. AUTORIZADO

MEX (55) 53 63 23 31

QRO (442) 1 95 72 60

MTY (81) 83 54 10 18

ventas@industrialmagza.com



WE MAKE THE WORLD MOVE



**INTERROLL
DRUM MOTORS
FOR UNIT
LOAD
HANDLING**

S U M M A R Y



Drum up more business



MEX (55) 53 63 23 31 MTY (81) 83 54 10 18
QRO (442) 1 95 72 60 ventas@industrialmagza.com

If you want to be the leader of the pack in your market, you need to be sure you can count on your partners, day and night, for solutions beyond the obvious as well as unmatched quality and service. This is synonymous with Interroll and its diversified range of Drum Motors, which are designed to tackle even the most difficult challenges in unit load handling applications.

Interroll Drum Motors, unique in concept and design, produce cutting-edge solutions, which will raise the overall efficiency and reliability of customer applications in materials handling the world over.

At the heart of the conveyor

Interroll Drum Motors have been specifically designed for belt conveyors and associated material handling equipment. This means that we take the worry and hard work out of your drive system, leaving you to do what you do best, designing the best conveyor for the application. But it doesn't stop there. We have over 50 years experience in the food processing industry and other extremely demanding industrial applications which we are happy to share with you (yes, we are all heart!) There is no doubt about it; the Interroll drive provides a quick and easy way of building maintenance-free, hygienic and energy-efficient belt conveyors. What more could you ask?

Ease of installation saves time and money

With fewer installation parts, Interroll Drum Motors are much quicker and easier to install than conventional drive systems, requiring less than a quarter of the time needed to fit a multi-component drive. Fewer parts mean cost reduction for conveyor design and purchasing of parts.

Built to withstand the worst conditions

With the entire drive mechanism totally enclosed in a steel shell sealed to IP66/67 standards, Interroll Drum Motors will keep operating at 100% in harmful environmental conditions such as water, dust, grit, chemicals, grease, oil and even during high pressure wash-down procedures.

Food grade quality

Tests have identified conventional external belt drive systems as being the main source of contamination in food processing. Interroll Drum Motors, however, eliminate this risk due to the smooth, profiled, stainless steel finish, totally sealed design and ingress protection of IP66 or IP67.

At least 32% more energy efficient

Independent test results showed Interroll Drum Motors used 32% less energy (unloaded) and 47% less energy (loaded) than a comparable geared motor drive.

Higher output

Interroll Drum Motors have a much higher efficiency than conventional drives, which normally transfer approximately 75% of their mechanical efficiency to the belt, compared to the Interroll drive which transfers up to 97%.

Space-saving design

Because the drive unit and bearings are mounted within the drum shell, the Drum Motor takes up much less space than conventional drives such as gear motors. No need for costly extras like chains, v-belts, couplings, bearings, support structures and special guarding.

Safe and sound working environment

An Interroll Drum Motor enhances the safety of your working environment. As a self-contained component without protruding parts and with fixed external shafts, it is probably the safest drive unit available for state-of-the-art material handling equipment. The only moving parts are the drum shell and bearing housings.

What is more, our new Drum Motors incorporating durable high grade polished steel gears, reduce previous sound levels by 18% and are therefore quieter than many other drives found in the market today.

Maintenance-free operation

End-users benefit from an Interroll Drum Motor because it requires absolutely no maintenance. The sealed-for-life Drum Motor design ensures trouble-free conveying of foodstuffs, unit loads or parts under the most arduous conditions. No maintenance results in lower operating costs and higher productivity.





Interroll Drum Motor 80s and 113s

Standard

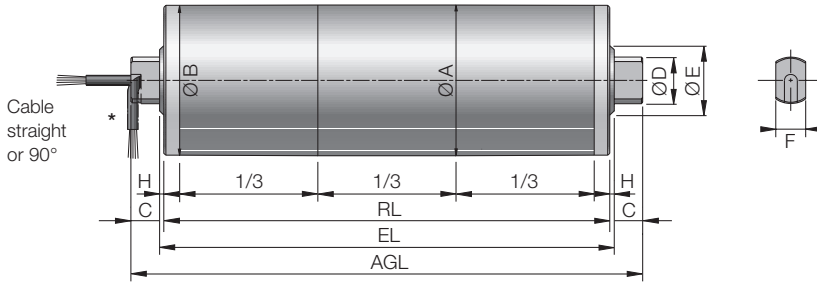

* Allow 2.2 mm for cable protrusion.

Stainless steel, TS
Cable straight

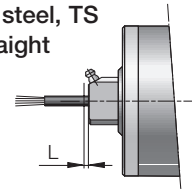

Terminal box

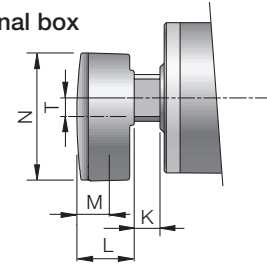

Drum motor Type	Width RL mm	A mm	B mm	C mm	D mm	E mm	F mm	H mm	K mm	L mm	M mm	N mm	T mm	EL mm	AGL mm	Min. RL mm
80s (shaft cap)	270 – 611	81.5	80	20	35	45	21	3	18	41	24	95	14	RL+6	RL+46	270
80s (shaft cap)	612 – 962	83	81	20	35	45	21	3	18	41	24	95	14	RL+6	RL+46	-
113s (shaft cap)		113.3	112.3	20	35	45	21	3	18	41	24	95	14	RL+6	RL+46	262

Interroll Drum Motors 80i, 113i, 138i, 165i, 216s

Standard with terminal box

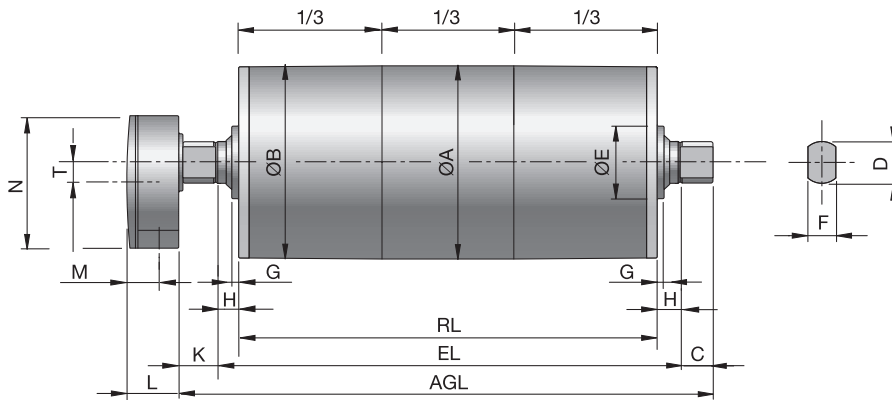

Straight connector

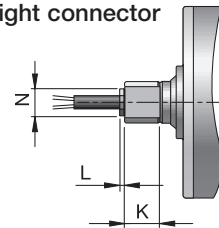

Elbow connector

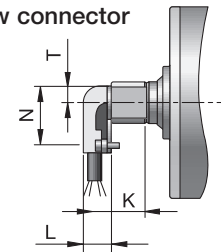

Drum motor Type	Drum motor								Terminal box					Straight connector			Elbow connector			EL mm	AGL mm	Min. RL mm	
	A mm	B mm	C mm	D mm	E mm	F mm	G mm	H mm	K mm	L mm	M mm	N mm	T mm	K mm	L mm	N mm	K mm	L mm	T mm				
80i	82	81	12.5	17	-	13.5	-	2.5	12.5	-	-	-	-	12.5	0	-	-	-	-	-	RL+5	RL+30	200
80i (shaft cap)	82	81	20	35	45	21	-	3	20	-	-	-	-	20	0	-	-	-	-	-	RL+6	RL+46	200
113i	113.5	112	25	25	-	20	-	5	23	41	24	95	14	25	4	19.5	25	24	12	-	RL+10	RL+60	260
113i (shaft cap)	113.5	112	20	35	45	21	-	3	19	41	24	95	14	20	0	-	-	-	-	-	RL+6	RL+46	300
138i	138.5	137	23.5	30	54	20	5	16.5	23.5	41	24	95	14	25.5	4	19.5	25.5	24	12	-	RL+33	RL+80	300
165i	165	163.5	43.5	40	80	30	10	21.5	41.5	41	24	95	14	43.5	4	27	43.5	24	12	-	RL+43	RL+130	350
216s	216	214.5	43.5	40	105	30	8.5	21.5	41.5	41	24	95	14	43.5	4	27	43.5	24	12	-	RL+43	RL+130	350



MEX (55) 53 63 23 31 MTY (81) 83 54 10 18
 QRO (442) 1 95 72 60 ventas@industrialmagza.com

Diameter mm	Type	Phase									
81	80s	1-phase	Power	kW	0.025	0.05	0.075	0.085	0.11	-	-
			Belt Speed	m/s	0.05 – 0.44	0.10 – 0.88	0.12 – 0.88	0.15 – 0.88	0.16 – 0.88	-	-
			Belt Pull	N	425 – 50	425 – 50	530 – 75	480 – 85	585 – 115	-	-
81	80s	3-phase	Power	kW	0.06	0.05	0.075	0.085	-	-	-
			Belt Speed	m/s	0.08 – 0.44	0.10 – 0.88	0.12 – 0.88	0.15 – 0.88	-	-	-
			Belt Pull	N	530 – 105	425 – 50	530 – 75	485 – 85	-	-	-
81	80i *	1-phase	Power	kW	0.05	0.08	-	-	-	-	-
			Belt Speed	m/s	0.1 – 0.47	0.22 – 0.99	-	-	-	-	-
			Belt Pull	N	480 – 106	340 – 75	-	-	-	-	-
81	80i *	3-phase	Power	kW	0.018	0.07	0.12	-	-	-	-
			Belt Speed	m/s	0.05 – 0.22	0.10 – 0.46	0.22 – 0.99	-	-	-	-
			Belt Pull	N	350 – 80	655 – 145	515 – 115	-	-	-	-
113	113s	1-phase	Power	kW	0.06	0.11	-	-	-	-	-
			Belt Speed	m/s	0.12 – 0.98	0.12 – 0.98	-	-	-	-	-
			Belt Pull	N	415 – 55	765 – 100	-	-	-	-	-
113	113s	3-phase	Power	kW	0.04	0.11	0.16	0.18	0.33	-	-
			Belt Speed	m/s	0.07 – 0.16	0.13 – 1.06	0.19 – 1.06	0.22 – 1.06	0.38 – 2.12	-	-
			Belt Pull	N	515 – 220	720 – 95	720 – 135	695 – 155	740 – 130	-	-
113	113i **	1-phase	Power	kW	0.08	0.18	0.23	-	-	-	-
			Belt Speed	m/s	0.11 – 0.42	0.17 – 0.50	0.38 – 1.49	-	-	-	-
			Belt Pull	N	695 – 180	970 – 345	565 – 150	-	-	-	-
113	113i **	3-phase	Power	kW	0.07	0.08	0.15	0.18	0.23	0.3	0.37
			Belt Speed	m/s	0.05 – 0.074	0.11 – 0.2	0.09 – 0.13	0.17 – 0.5	0.38 – 1.49	0.19 – 0.73	0.39 – 1.5
			Belt Pull	N	1370 – 885	695 – 384	1530 – 1125	970 – 345	565 – 148	1505 – 395	905 – 235
138	138i	1-phase	Power	kW	0.2	0.37	0.55	-	-	-	-
			Belt Speed	m/s	0.10 – 0.40	0.16 – 0.50	0.25 – 0.80	-	-	-	-
			Belt Pull	N	1990 – 500	2105 – 660	2270 – 645	-	-	-	-
138	138i	3-phase	Power	kW	0.1	0.18	0.24	0.37	0.55	0.75	1.00
			Belt Speed	m/s	0.04 – 0.10	0.08 – 0.20	0.10 – 0.32	0.13 – 0.80	0.25 – 1.60	0.32 – 1.60	0.50 – 1.60
			Belt Pull	N	2295 – 895	2350 – 890	2350 – 720	2425 – 430	2190 – 345	2295 – 475	2090 – 590
165	165i	1-phase	Power	kW	0.37	1.1	-	-	-	-	-
			Belt Speed	m/s	0.13 – 1.00	0.40 – 2.50	-	-	-	-	-
			Belt Pull	N	2750 – 390	2550 – 390	-	-	-	-	-
165	165i	3-phase	Power	kW	0.11	0.37	0.75	1.1	1.5	2.2	-
			Belt Speed	m/s	0.05 – 0.10	0.13 – 1.00	0.16 – 1.00	0.25 – 2.50	0.50 – 3.15	0.50 – 3.15	-
			Belt Pull	N	2070 – 1045	2865 – 360	4100 – 695	3940 – 415	2880 – 480	3990 – 675	-
216	216s	1-phase	Power	kW	0.37	1.1	-	-	-	-	-
			Belt Speed	m/s	0.16 – 1.25	0.50 – 3.15	-	-	-	-	-
			Belt Pull	N	2100 – 300	1945 – 295	-	-	-	-	-
216	216s	3-phase	Power	kW	0.11	0.37	0.75	1.1	1.5	2.2	-
			Belt Speed	m/s	0.06 – 0.13	0.16 – 1.25	0.20 – 1.25	0.32 – 3.15	1.00 – 4.00	1.00 – 4.00	-
			Belt Pull	N	1580 – 800	2190 – 280	3130 – 530	3010 – 315	1415 – 365	1995 – 515	-

* indicates other specification for RL 200 mm

** indicates other specification for RL 250 mm



A comprehensive package of solutions to suit your application



MEX (55) 53 63 23 31 MTY (81) 83 54 10 18
QRO (442) 1 95 72 60 ventas@industrialmagza.com

To suit individual applications, Interroll Drum Motors are available with a wide range of voltages, powers, speeds, high-torque motors, accessories and many other options.

Modular belting

Interroll provides pioneered drive solutions for modular plastic belt conveyors utilising a range of purpose-designed, food quality FDA approved profiled lagging.

Other options include profiled rubber and PU lagging, and stainless steel or polymeric sprockets.

Idler Pulleys

Choose from idler pulleys manufactured from mild steel, stainless steel or polypropylene.

Brackets for quick installation

Brackets make the installation of an Interroll Drum Motor quick and easy. They are available in aluminium, steel, cast iron and polyethylene. Screw adjustable tension brackets are also available.

Variable speed control

To provide maximum flexibility of speed and control, all Interroll Drum Motors can be connected with most types of frequency converters.

Frequency converter

Take advantage of our coordinated package, consisting of an Interroll Drum Motor supplied with a frequency converter pre-set and optimised with the motor parameters and on site "plug & play" facility, to:

- Vary the belt speed and direction for several systems or for auxiliary conveyor systems.
- Vary the belt speed and direction in machines, e.g., for various dispensing operations.
- Optimise the starting and reversing torque for intermittent stop/start & reversing operations.

These frequency converters can easily be integrated into simple or more complex control systems.

Encoder

For monitoring revolutions, speeds, distance and direction ask for an Interroll Drum Motor with integral incremental encoder.

The combination of drum motor, encoder and frequency converter permits high-levels of flexibility, drive control and system data feed back.

Direct interchangeability

Interroll can replace all other makes of drum motors in existing conveyor systems.

Repairs and servicing

Interroll offer a 24/7 hotline service and will repair or replace any make or model of motorised drum.

Ask for a cost comparison for a replacement.

Powered rotary brushes

Why do rotary brush manufacturers leave the construction of the driving mechanism up to the developer?

We make life easier for you: we build the motor inside the brush!

Whatever your needs, the maintenance-free drum motor is integrated into the rotary brush and can be mounted horizontally or vertically, saving you space and valuable time during construction.

Only the mounting of our active rotary brushes need to be designed and it is suitable for a wide range of applications including food processing, packaging, pharmaceutical and many other industries.

Big on small belts: Interroll NarrowDrive

Compact, powerful and reliable, this premium component drives belts as narrow as 68 mm at speeds of 0.06 up to 1.16 m/s in conveyors ranging in length from 250 mm to 2,000 mm. For quick and easy installation within the conveyor frame, the Interroll NarrowDrive is available as a complete solution consisting of a DC drive unit, a 50 mm idler roller complete with mounting brackets.

This space saving concept is ideally suited to replace geared motors in numerous narrow belt applications around the world.



Pallet Drive solutions

The Interroll Pallet Drive concept provides a space-saving, cost-effective and working environment friendly alternative to conventional driven rollers using gear motors with chains or belts and to outdated manual methods of pallet

transportation in packaging, distribution, and logistics centres. Pallet Drives, driven Rollers and Slave Rollers are designed to fit most common pallet conveyor modules and are suitable for handling all standard pallet sizes for maximum loads of up to 1,000 kg.

This unique concept provides full ZPA functionalities for straight modules, turntables, transfer cars and other transfers.

Optional power

To expand the field of operations, where electricity is unavailable or undesirable, Interroll offer a full range of hydraulic powered drum motors.



Made to perform – beyond all boundaries

Powered or gravity driven: Our product range represents a reliable quality standard for dynamic, efficient material flow across all continents and in all sectors.

With an experienced eye for the big picture, we offer you the kind of components that are versatile and essential building blocks in the portfolio of any successful planner or developer.



DRIVES & ROLLERS



MEX (55) 53 63 23 31 MTY (81) 83 54 10 18
QRO (442) 1 95 72 60 ventas@industrialmagza.com

Europe/Nordic

Denmark

Interroll Nordic A/S
Hammerholmen 2-6
DK-2650 Hvidovre/Denmark
Tel. +45 36 88 33 33
Fax +45 36 88 33 72
dk-sales@interroll.com

Interroll Service
Islandsvej 5
DK-7900 Nykøbing M.
Tel. +45 97 71 15 55
Fax +45 97 71 16 55
dk-sales@interroll.com

Iceland

IBH ehf
Dugguvogur 10
104 Reykjavik
Iceland
Tel. +354 562 6858
Fax +354 562 6862
ingi@ibh.ehf.is

Finland

Tel. +358 9 54 94 94 00
Fax +358 9 54 94 94 16

Norway

Tel. +47 32 88 26 00
Fax +47 32 88 26 10

Sweden

Tel. +46 35 227077
Fax +46 35 227078

Western/Southern Europe

France

Interroll S.A.S.
ZI de Kerannou
B.P. 34
F-29250 Saint Pol de Léon
Tel. +33 298 24 41 00
Fax +33 298 24 41 02
f-sales@interroll.com

Italy

Rulli Rulmeca S.p.A.
Via A. Toscanini, 1
I-24011 Almè (Bg)
Tel. +39 035 4300111
Fax +39 035 545523
i-sales@interroll.com

Portugal

Rulmeca Interroll de Portugal Lda
Apartado 69, Centro Cívico
P-6201-909 Covilhã
Tel. +351 275 330 780
Fax +351 275 330 789
p-sales@interroll.com

Spain

Interroll España S.A.
C.I. Santiga
C/Puig dels Tudons, 5
E-08210 Barberà del Vallès
Tel. +34 93 729 96 50
Fax +34 93 718 96 50
e-sales@interroll.com

United Kingdom

Interroll Ltd.
Brunel Road
Earlstrees Industrial Estate
GB-Corby, Northants NN17 4UX
Tel. +44 1536 200 322
Fax +44 1536 748 505
gb-sales@interroll.com

Central Europe

Germany

Interroll Fördertechnik GmbH
Höferhof 16
D-42929 Wermelskirchen
Tel. +49 2193 23 0
Fax +49 2193 20 22
d-sales@interroll.com

Austria

Tel. +49 2193 23 187
Fax +49 2193 23 164

Belgium

Tel. +49 2193 23 131
Fax +49 2193 23 164

Luxembourg

Tel. +49 2193 23 190
Fax +49 2193 23 164

Netherlands

Tel. +49 2193 23 151
Fax +49 2193 23 164

Switzerland

Tel. +49 2193 23 190
Fax +49 2193 23 164

Benelux

BDL Trommelmotoren b.v.
Veldweg 38
NL-6075 Herkenbosch
Tel. +31 4755 33701
Fax +31 4755 32597
nl@bdldrummotors.com

Eastern Europe

Germany

Interroll Fördertechnik GmbH
Höferhof 16
D-42929 Wermelskirchen
Tel. +49 2193 23 126
Fax +49 2193 23 164
d-sales@interroll.com

Hungary

Tel. +36 23 337 891
Fax +36 23 337 892

Poland

Interroll Polska Sp. z o.o.
ul. Jagiellońska 78
lok. 3.31
PL-03-301 Warszawa
Tel. +48 22 334 63 43
Fax +48 22 675 72 92
pl-sales@interroll.com

Slovakia

Tel. +421 2 4363 8102
Fax +421 2 4342 7294

Slovenia

Tel. +386 1 56 56 370
Fax +386 1 56 56 372

Czech Republic

Interroll CZ S.R.O.
Ulice G.Simka 3147
CZ-69003 Breclav
Tel. +420 627 330 210
Fax +420 627 330 211
cz-sales@interroll.com

Turkey

Roller Makina San. Ve. Tic. Ltd. Sti.
Zihni Sakaryali Ali Sok.
Ufuk Apt. No. 1 D. 11
Ersoy Sahil Sitesi
81070 Suadiye
Istanbul
Tel. +90 216 386 37 75
Fax +90 216 386 38 22
tr-sales@interroll.com

Near East

Israel

ComTrans Engineering Ltd.
5 Hahoma Street
Rishon le-Zion 75655
Tel. +972 3 961 96 36
Fax +972 3 961 96 44
il-sales@interroll.com

Africa

South Africa

Interroll SA Pty. Ltd.
P.O. Box 327
Isando 1600
ZA-Gauteng
Tel. +27 11 974 1901
Fax +27 11 974 1896
za-sales@interroll.com

North & South America

USA

Interroll Corporation
3000 Corporate Drive
USA-Wilmington, NC 28405
Tel. +1 910 799 11 00
Fax +1 910 392 38 22
usa-sales@interroll.com

Canada

Interroll Canada Ltd.
1201 Gorham Street
CDN-Newmarket
Ontario L3Y 8Y2, Canada
Tel. +1 905 727 3399
Fax +1 905 727 3299
cdn-sales@interroll.com

Argentina

Interroll South America
Calle 117, No. 3591
B1650NRU San Martin
Provincia de Buenos Aires
Tel. +54 11 4753 8005
Fax +54 11 4754 1332
ar-sales@interroll.com

Brasil

Interroll Brasil
Av. Portugal 918
CEP 06651-970
Itapevi - SP
Tel. +55 11 41 43 43 43
Fax +55 11 41 43 77 19
br-sales@interroll.com

Asia

China

Interroll (Suzhou) Co. Ltd.
Unit 10B, Modern Industrial Square
No. 333 Xing Pu Road
Suzhou Industrial Park
Suzhou, Jiangsu Province
People's Republic of China
Postal Code: 215126
Tel. +86 512 6256 0383
Fax +86 512 6256 0385
cn-sales@interroll.com

Japan

Interroll Japan Co. Ltd.
302-1 Shimokuzawa
Sagamihara-shi
JPN - Kanagawa 229-1134
Tel. +81 42 764 2677
Fax +81 42 764 2678
jpn-sales@interroll.com

Korea

Interroll Korea Corporation
Room 301, Dongsan Bldg, 333-60
Shindang-Dong, Choong-ku
Seoul
Tel. +822 2 231 1900
Fax +822 2 254 36 83
kr-sales@interroll.com

Singapore

Interroll (Asia) Pte. Ltd.
386 Jalan Ahmad Ibrahim
629156 Singapore
Republic of Singapore
Tel. +65 6266 6322
Fax +65 6266 6849
sgp-sales@interroll.com

Thailand

Interroll (Thailand) Co. Ltd.
41/6 Moo 6, Bangchalong,
Bangplee
Samutprakarn 10540
Tel. +66 2 337 0188 91
Fax +66 2 337 01 92
th-sales@interroll.com

Australia & New Zealand

Australia

Conveyor Solutions Australia Pty. Ltd.
70 Keon Parade
Thomastown 3074
Melbourne
Tel. +61 3 9460 2155
Fax +61 3 9460 2029
aus-sales@interroll.com

New Zealand

Anthony Group (NZ) Ltd.
42 Parkway Drive
Mairangi Bay
NZ-Auckland 10
Tel. +64 9 478 6150
Fax +64 9 479 6394
nz-sales@interroll.com

For other countries please see
contacts at www.interroll.com