

Series "F" Full Flex And Flex Rigid Couplings For TAPER-LOCK® Bushings

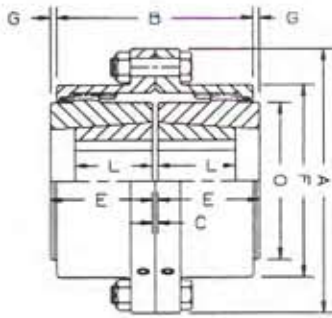

**Full Flex - Standard Mount
Inboard - Inboard**

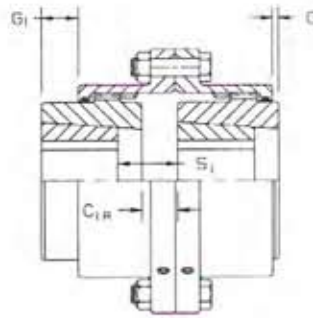

**Full Flex - One Hub Reversed
Outboard - Inboard**

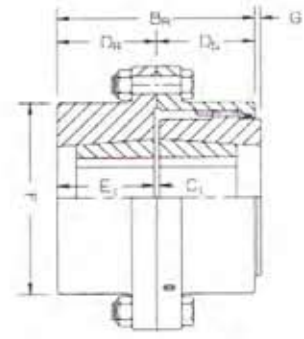

**Flex Rigid - Standard Mount
Inboard - Inboard**

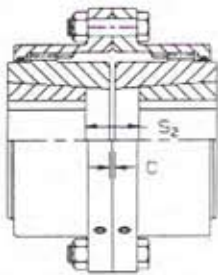

**Full Flex - Standard Mount
Outboard - Outboard**

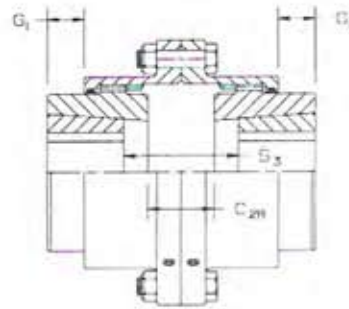

**Full Flex - Both Hubs Reversed
Outboard - Outboard**

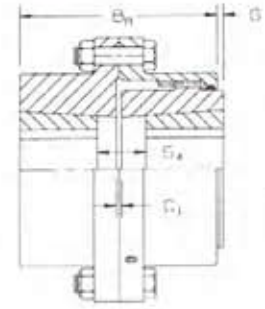

**Flex Rigid - Standard Mount
Outboard - Outboard**

Series F	Size	1	1½	2	2½	3	3½	4
Rating (HP/100 RPM)	(2)	4	8	15	29	50	80	120
Torque Capacity (IN-LBS x 10 ³)		2.5	5	9.5	18.3	31.5	50.4	75.6
Maximum Speed (RPM)	(1)	6900	5660	4850	4100	3650	3180	2710
DTL Bushing Number		1215	1615	2012	2525	3030	3535	4040
Parallel Offset Capacity		.056	.069	.089	.108	.128	.153	.176
A		4.56	6.00	7.00	8.38	9.44	11.00	12.50
B		3.31	3.88	4.84	6.00	6.94	8.38	9.34
C		.13	.13	.13	.19	.19	.25	.25
C1R		.38	.72	.98	1.09	1.38	1.72	1.97
C2R		.75	1.31	1.84	2.00	2.56	3.19	3.69
E		1.69	1.94	2.44	3.03	3.59	4.19	4.75
F		3.11	3.91	4.88	5.91	6.88	7.91	9.25
G		.09	.06	.06	.13	.22	.13	.20
G1		.41	.66	.89	1.03	1.31	1.59	1.92
O		2.36	3.05	3.97	4.88	5.63	6.50	7.75
L		1.50	1.50	1.25	2.50	3.00	3.50	4.00
S1		.75	1.59	3.36	2.16	2.56	3.09	3.47
S2		.50	1.00	2.50	1.25	1.38	1.63	1.75
S3		1.13	2.19	4.22	3.06	3.56	4.56	5.19
S4		1.50	1.50	1.25	2.50	3.00	3.50	4.00

Notes:

- (1) Speed limits are recommendations based on experience and are intended as a guide only. Consult SCI for speeds higher than those listed.
- (2) Load ratings / torque capacities are based on bushing size. Selection service factors are required. See Data Sheet DS110.
- (3) Maximum angular misalignment 1 1/2° per gear mesh. For optimum performance, combined angular and offset misalignment should not exceed 3/4° per gear mesh. Application requirements in excess of 3/4° misalignment per flex half coupling should be referred to SCI.

Consult engineering for larger sizes.

Flex hubs or rigid hubs can be provided with either inboard or outboard mount bores.

Unless otherwise specified standard mount with inboard - inboard hubs supplied.



MAGZA
DIST. AUTORIZADO

MEX (55) 53 63 23 31 MTY (81) 83 54 10 18
QRO (442) 1 95 72 60 ventas@industrialmagza.com