

POWERTORK®

DATA SHEET DS102 REV. 03

Series "F" Rigid Rigid Flange Type Gear Coupling.

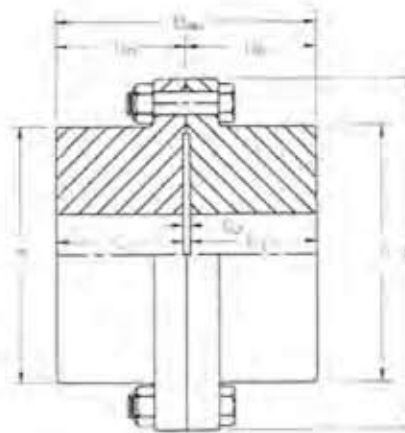

Series F	Size	1	1½	2	2½	3	3½	4	4½	5	5½	6	7
Rating (HP/100 RPM)		15.5	31	51	90	152	240	380	500	710	925	1200	1850
Torque Capacity (IN · LBS x 10 ³)		9.77	19.5	32.1	56.7	96	151	240	315	447	583	756	1166
Maximum Speed (RPM)	(1)	10800	8800	8300	7670	7150	6330	5670	5160	4650	4350	3820	3150
Rigid Hub	Maximum Bore	2.25	2.75	3.25	4.38	5.00	5.63	6.75	7.75	8.88	9.50	10.75	12.63
	Standard Keyway	1/2 x 1/4	5/8 x 5/16	3/4 x 3/8	1 x 1/2	1-1/4 x 5/8	1-1/2 x 3/4	1-3/4 x 3/4	2 x 3/4	2 x 3/4	2-1/2 x 7/8	2-1/2 x 7/8	3 x 1
Hub	Maximum Bore	2.44	3.00	3.50	4.50	5.50	6.13	7.00	8.25	9.13	10.00	11.00	13.13
	Reduced Depth Keyway	5/8 x 3/16	3/4 x 3/16	7/8 x 1/4	1 x 3/8	1-1/4 x 3/8	1-1/2 x 1/2	1-3/4 x 5/8	2 x 1/2	2-1/2 x 5/8	2-1/2 x 5/8	2-1/2 x 5/8	3 x 3/4
A		4.56	6.00	7.00	8.38	9.44	11.00	12.50	13.63	15.31	16.75	18.00	20.75
BRR		3.31	3.84	4.75	6.00	7.00	8.12	9.22	10.34	11.72	12.61	15.31	18.00
C2		.19	.19	.19	.19	.19	.19	.38	.38	.38	.50	.50	.63
DR		1.65	1.92	2.38	3.00	3.50	4.06	4.61	5.17	5.86	6.30	7.66	9.00
E1		1.56	1.84	2.28	2.91	3.41	3.97	4.42	4.98	5.67	6.05	7.41	8.69
F		3.11	3.91	4.88	5.91	6.88	7.91	9.25	10.31	11.56	12.59	13.88	16.09
Rough Stock Bore		-	-	-	-	-	-	2.09	2.25	2.25	2.75	3.00	4.00
Weight Solid Hubs (LBS)		(2)	9	18	30	59	83	131	200	268	386	465	988

Notes:

- (1) Maximum speed without dynamic balancing 60% of values shown. Speed limits are recommendations based on experience and are intended as a guide only. Consult SCI for speeds higher than those listed.
- (2) Weights are for rigid rigid couplings. Weights are approximate.
- (3) Sizes 5½, 6 and 7 not available in shrouded bolt.