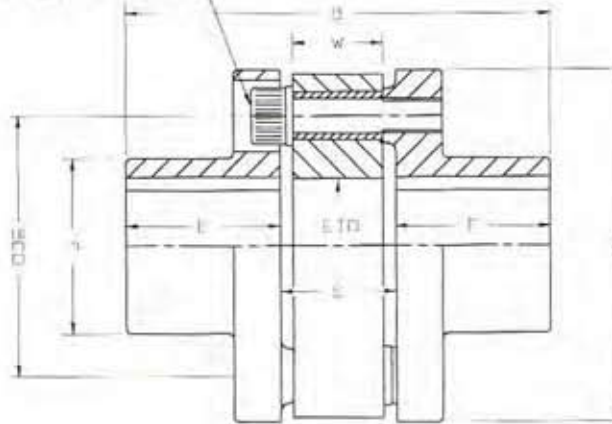

FLEXTORK®**Series "EL" Couplings - Sizes 80 thru 130**

(non-published)

(N) TT SOCKET HEAD
CAP. SCREWS WITH
HARDENED FLAT WASHERS

Series EL	Size	80	90	100	110	120	130
Rating (HP/100 RPM)		83.1	120.6	165.6	227.5	289.3	358.1
Torque Capacity (IN·LBS x 10 ³)(2)		52.36	76.03	104.38	143.38	182.33	225.69
Maximum Speed (RPM)	(3)	2400	2100	1800	1650	1450	1350
Maximum Bore	(4)	8.25	10.00	12.50	13.75	16.00	18.00
Standard Keyway	(4)	2 x 3/4	2-1/2 x 7/8	3 x 1	3-1/2 x 1-1/4	4 x 1-1/2	4 x 1-1/2
A		15.25	17.68	20.19	22.63	25.16	27.75
B		13.94	13.94	14.19	14.19	14.69	15.19
C		2.19	2.19	2.19	2.19	2.19	2.19
E		5.88	5.88	6.00	6.00	6.25	6.50
EID		9.25	11.85	14.44	16.93	19.49	22.00
F	Dependant on shaft sizes - Per Order Basis.						
BCD		12.756	15.197	17.717	20.157	22.677	25.157
N		10	12	14	16	18	20
TT		M24	M24	M24	M24	M24	M24
W		1.46	1.46	1.46	1.46	1.46	1.46
Max. Angular Misalignment (DEG)		2	2	2	1	1	1
Bolt Tightening Torque (FT·LBS)		500	500	500	500	500	500

Notes:

- (1) Maximum offset misalignment up to .04"
- (2) Continuous load rating is based on a 1.0 x Safety factor.
Maximum peak load rating is 4.0 x continuous load rating.
- (3) Maximum speed 60% of value shown without dynamic balancing.
- (4) Customer to specify if coupling is to be furnished with interference fit or furnished with Class 1 clearance fit bores with one keyway and one set screw over the keyway per hub unless otherwise specified.
Finish bores and keyways are per AGMA 9002-A86 commercial standards.

EL-2

**INDUSTRIAL MAGZA**
DIST. AUTORIZADOMEX (55) 53 63 23 31 MTY (81) 83 54 10 18
QRO (442) 1 95 72 60 ventas@industrialmagza.com